

**StarBoard**  
**FX-79E1 | FX-89WE1**



**DUAL INSPIRATION,  
UNLIMITED POTENTIAL**

**Product Features**

- **Finger-driven technology** – Use your finger or a stylus pen to operate
- **Multi-touch** – Use your finger to annotate, fist to scroll and two fingers to erase or zoom in and out
- **Dual-Pen** – Two users can write and work on the StarBoard simultaneously
- **Robust surface** – The surface is robust and the StarBoard works even if there are scratches/dents on the surface
- **Low reflection** – Projector reflection is minimized making it gentle to the eyes



## Software Features

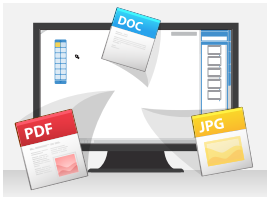

### IMPORT

Import a variety of documents into the software, including Microsoft® Office®, PDF, and multi-media files, enabling instant markup. Save your work to share with colleagues or for future use. You can also embed and annotate over motion video, adding dimension to your digital lectures and presentations.

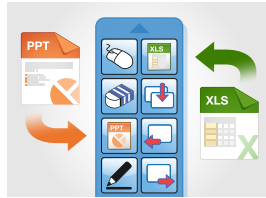

### CUSTOMIZE

Add external files and applications to the software toolbar, with the option to save it for future use. You can expand or collapse the toolbar and adjust its height and orientation based on your preference. Work in full-screen mode or add in multiple menu options for more accessibility.

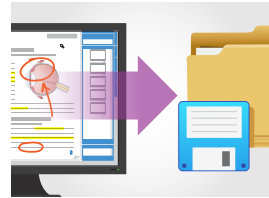

### ANNOTATE

With the StarBoard Software's virtual printer, you can transfer any file to your whiteboard page to review and markup with digital ink. The print to StarBoard feature gives you the option of editing and saving your work in a variety of file formats, such as JPEG, PDF, or PPT for ultimate compatibility.

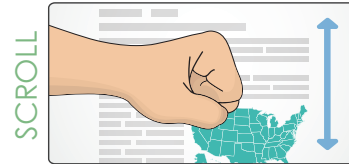

SCROLL

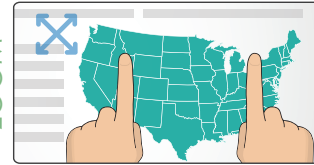

ZOOM

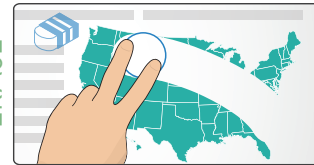

ERASE

### GESTURE

Operate the StarBoard intuitively using the built-in software gestures to zoom, right click, scroll or erase without the need to switch between tools or use the mouse.

## Specifications

	StarBoard FX-79E1	StarBoard FX-89WE1
<b>Product Name</b>	StarBoard FX-79E1	StarBoard FX-89WE1
<b>Model No.</b>	AH00329	AH00332
<b>Input Method</b>	Infrared Ray Shading Detection System	
<b>Interface to Computer</b>	USB 1.1, 2.0 compatible	
<b>Active Area Size</b>	79" (aspect ratio 4:3)	89" (aspect ratio 16:10)
<b>Dimensions</b>	1,852 mm(W) x 1,282 mm(H) x 35 mm(D)	2,179 mm(W) x 1,282 mm(H) x 35 mm(D)
<b>Mass (weight)</b>	approx. 22 kg (20 – 24 kg)	approx. 24 kg (22 – 26 kg)
<b>Packing Dimensions</b>	1,975 mm(W) x 1,405 mm(H) x 90 mm(D)	2,300 mm(W) x 1,405 mm(H) x 90 mm(D)
<b>Packing Mass (weight)</b>	approx. 33 kg (31 – 35 kg)	approx. 37 kg (35 – 39 kg)
<b>Operating Specification</b>	Temperature range: +5 – +35 °C, Humidity: 20 – 80% (without condensation)	
<b>Certifications</b>	FCC Class B, VCCI Class A, CE	
<b>System Configuration</b>		

## System Requirements

<b>Windows®</b>	
<b>CPU</b>	Intel® Pentium® 4 processor with 1.8GHz or higher
<b>RAM</b>	1GB or more is recommended
<b>HDD</b>	600MB of free space
<b>Display Colors</b>	32bits or more
<b>Operating System (OS)</b>	Microsoft Windows® XP 32bit / Windows® Vista 32bit / Windows® 7 32/64bit (latest service pack must be applied) (Tablet PC and Server Edition are not supported)
<b>Software Required</b>	StarBoard Software 9.43 or later
<b>Macintosh</b>	
<b>CPU</b>	Intel® CPU
<b>RAM</b>	1GB or more
<b>HDD</b>	600MB of free space
<b>Display Colors</b>	High Color (16bit) or more
<b>Operating System (OS)</b>	Mac OS X 10.5 / 10.6 / 10.7.4
<b>Software Required</b>	StarBoard Software 9.43 or later

• StarBoard is a registered trademark of Hitachi Solutions, Ltd. in Japan and other countries. • All other trademarks and trade names are the property of their respective owners.  
• All designs and specifications are subject to change without notice or obligation.

For questions and inquiries regarding our products and services, contact:

**Hitachi Solutions, Ltd.**

<http://www.hitachi-solutions.com/>

**Email** [starboard-intl-sales@hitachi-solutions.com](mailto:starboard-intl-sales@hitachi-solutions.com)

**URL** <http://www.hitachi-solutions.com/starboard-asia-oceania/sp/>